

Energy-efficient

The building acts as a thermostat that adapts to weather changes and controls optimal conditions each season. It can be closed in winter or open in summer and it can provide protection from the sun by a canopy canopy or an awning. The opening and closing mechanisms that modify the interior space also modify the light and shadows.

With these mechanisms the building doesn't need an extra energy to heat or cool. The building adapts when the climate is extreme.

Use of the space after through the branches of trees

Visual perception of the movements through the shadows

Visual connection with the kitchen and the work of cooks and visitors

Kitchen with natural lighting and visual connection to the room

Lower bound of trees, vision of the lesser-known restaurant

Cleanhouse as working element

FAKRO makes this building come true

The building is made by a composition of FAKRO windows in the whole building. Using FTP-V U3, FTU-V U3 pivot window and BDL L3 window with EU NAB. On the roofs and vertical windows. For the interior of the building which is under the ground I used FAKRO Light Tunnel SRT with SL2 flashing. To generate energy I used solar collector SKC FAKRO with CPVM2V flashing for profiled roofing materials.

Copying trees

In the case of the building, spaces between the trees, the structure of masts and supports besides the slope of a line give the building the feeling of being suspended in the forest, as if it were raised from the ground and blended with the forest. In addition, areas permeable also to future development.

The performance creates new visions of the forest, you can see the environment from an upper level, from the side of the forest and above the trees. Also increases the view through the landscape.

Inside the building between and over the tops of the trees, paths and spaces without doors are placed by overhangs that introduce nature, light, light and reflections inside the restaurant. The intention is to suggest the space without seeing it, generating new structures using reflections and reflections because of the great the plastic elements.

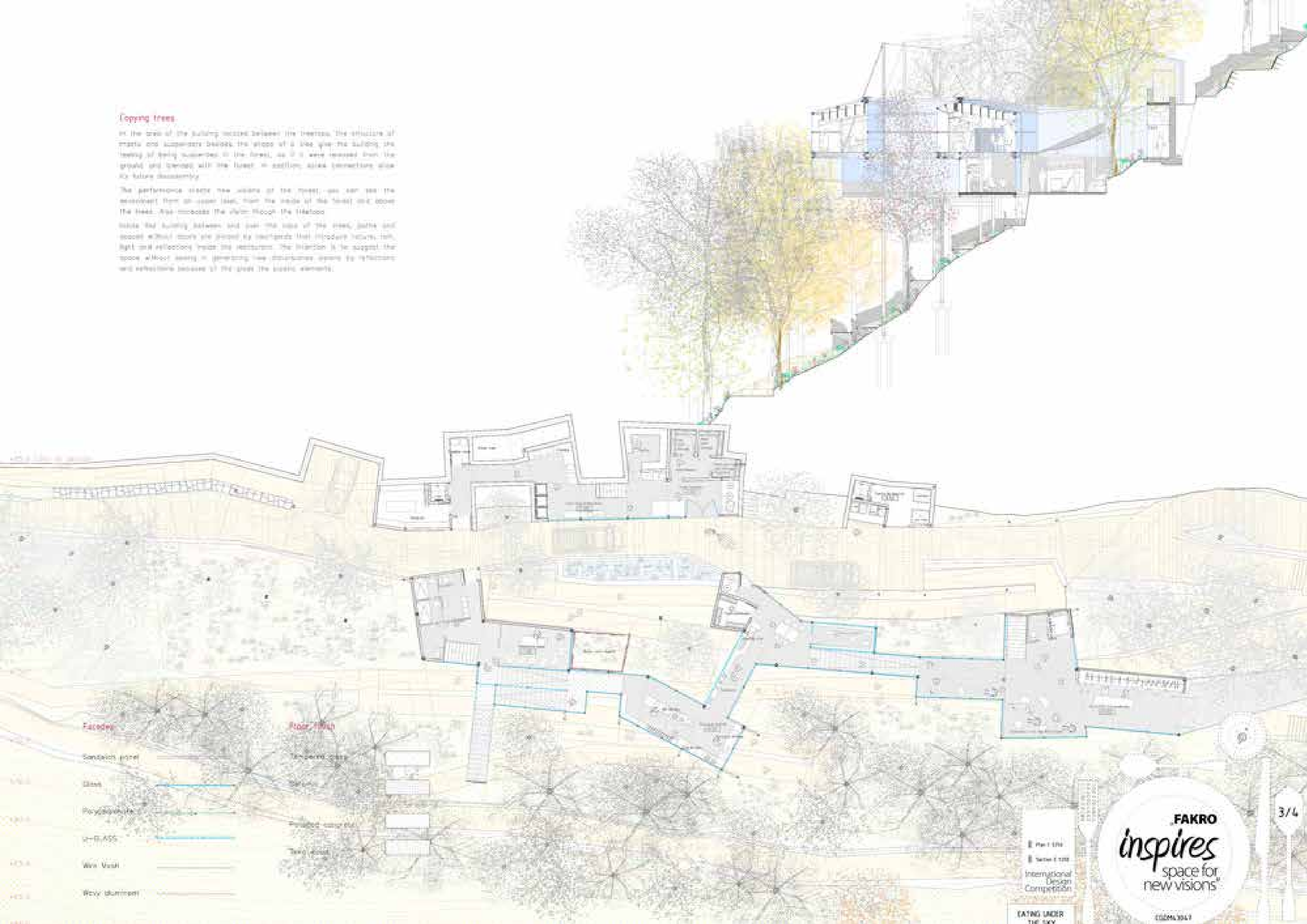

Facades

- Sandwich panel
- Steel
- Polypropylene
- U-GLASS
- Wire Mesh
- Wavy aluminum

Floor Finish

- Textured concrete
- Stone
- Polished concrete
- Thin wood

1st floor
2nd floor
International Design Competition



EATING UNDER THE SKY

100MA001

The restaurant to enjoy the nature through the transparency

The restaurant has no building facade, it is the actual forest that serves as its facade. This is because the building is made by transparent or translucent elements standing in with its surroundings. The restaurant is built in the woods so that the visitors feel as if they disappeared into the forest. The roof, walls, and floor are made of the same material. However, the walls are used to generate reflections and sounds. Light source elements were to show the wood texture. Transparent elements provide light effects and colors. The wood creates warmth and unique sounds of the forest. Finally, a net is used to catch the tree leaves and generate the ambience of falling leaves in the forest.



- Facades**
- Double-pane
 - Clear
 - Polycarbonate
 - U-GLASS
 - Wire Mesh
 - Wavy aluminum

- Floor finish**
- Marble tiles
 - Concrete
 - Polished concrete
 - Teak planks

FAKRO
International
Design
Competition
**EATING UNDER
THE SKY**

FAKRO
inspires
space for
new visions®
EGDPM 3041



International Design Competition

EATING UNDER THE SKY

FAKRO
inspires
space for new visions™

EGDM13043

1/4